

FORM NO 1.

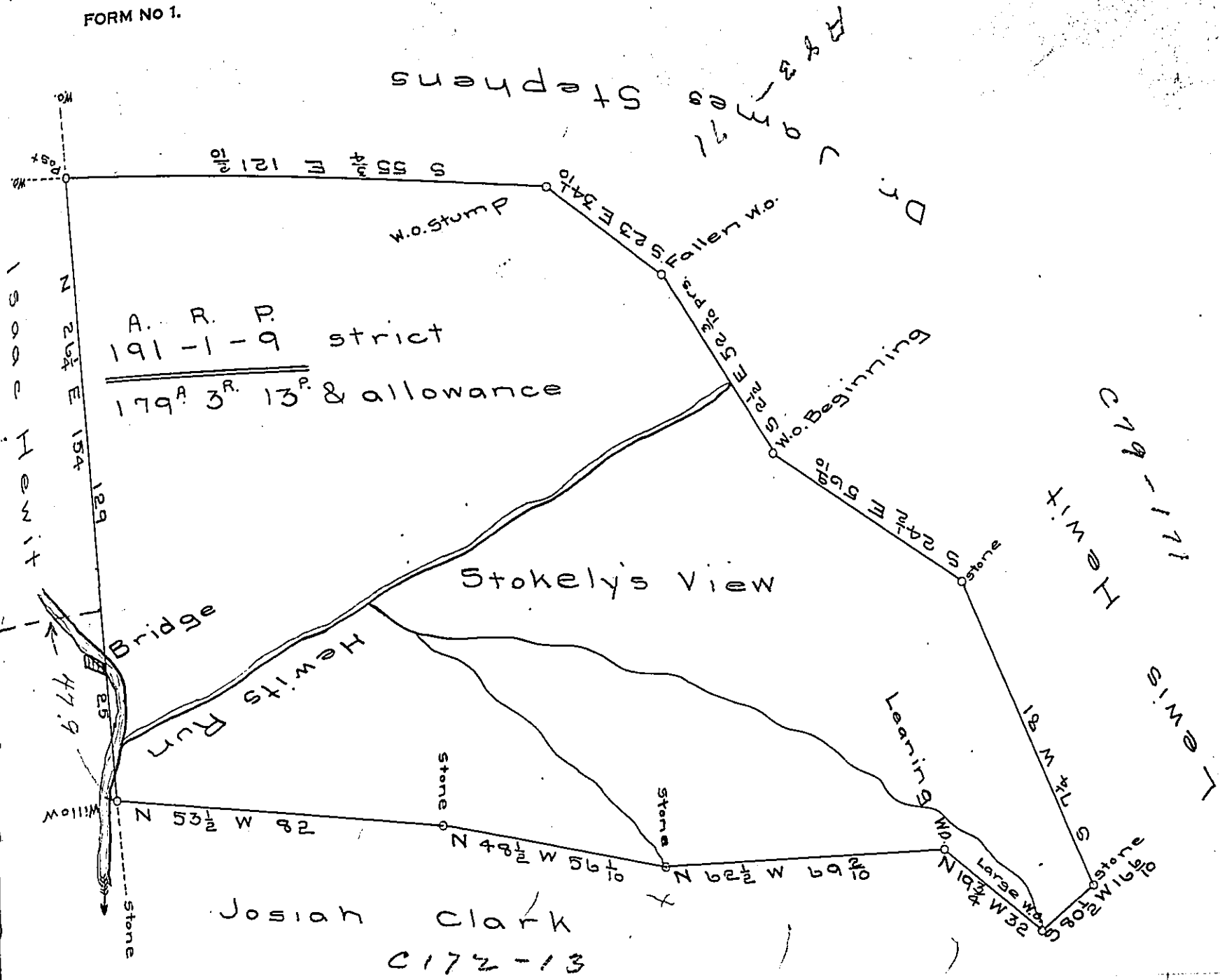

The above is a draught of a survey made for William Wylie Junellth 1841 containing 191 acres 1 quarter & 9 perches strict measure, or 179 acres 3 quarters & 13 perches with the usual allowance - situated in Canton township, on the waters of Chartiers creek Washington County, Penna.

E.G.

N.B. the above survey called "Stokely's View" was surveyed June 2^d 1787 in pursuance of a warrant

IN TESTIMONY that the above is a copy of the original remaining on file in the Department of Internal Affairs of Pennsylvania, made conformably to an Act of Assembly approved the 16th day of February, 1833, I have hereunto set my Hand and caused the Seal of said Department to be affixed at Harrisburg, this eighth day of March 1907.

Laurel B. Brown
Secretary of Internal Affairs.